

TOP VIEW

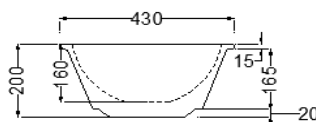

SIDE VIEW

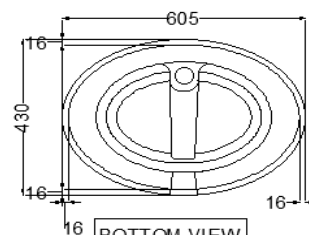

BOTTOM VIEW

#### GENERAL INFORMATION

Product Code	CNS-WHT-705
Brand	Jaquar
Colour	White
Type	Under counter basin
Material	Ceramic-Vitreous China (VC)

#### PRODUCT SPECIFICATION

Product Dimension	605x430x200 mm
Basin Inner Dimension	545x370x160 mm
Product Net Weight	11.7 kg.
Product Gross Weight	12.9 kg
Packaging Dimension	615X450X230 mm
Outlet	Vertical
Waste Hole Dimension	Internal diameter of outlet hole dia. Ø45 +2/-1 mm
	Horizontal distance between the Bowl edge and the center line of the waste outlet hole ≤ 115 mm

#### PRODUCT FEATURES

Product Feature	Oval Shaped under counter with over flow hole cap, Anti germ glaze
-----------------	--

#### ACCESSORIES INCLUDED

Over flow hole cap	ZPS-WHT-9012B
UC Screw(clamp)	ZPS-MST-FB06
Template	Installation Template

#### CARE AND CLEANING GUIDELINES

- Vitreous china sanitary ware products are fragile in nature and need to be handled with care (to avoid personal injury) at all times during its storage, handling, installation and use thereafter.
- The product is heavy and it is recommended that two persons hold it while it is being fixed.
- Carefully inspect the new product for damage before installation. Recommended to inspect the sanitaryware with wooden Hammer.
- Risk of product damage. Over tightening may cause breakage or chipping of vitreous china. Recommended to use hard rubber & nylon spacer in between ceramic & metal fixtures.
- Risk of external leakage. Do not lift or rock the bowl after placement.
- Always test your cleaning solution on an inconspicuous area on the product before applying it to the entire surface.
- Do not allow cleaners to sit or soak on the product.
- Use a soft, dampened sponge or cloth to clean. Never use abrasive material like a bristle brush or scouring pad.
- Wipe surfaces clean and rinse completely with water immediately after applying cleaners.
- Clean Chrome, stainless steel surfaces once a week. Do not use cleaners containing chloride on chrome, stainless steel. If used, rinse the surface immediately to prevent corrosion.
- Wherever chrome plating is used on the products, use only warm water to clean and then dry with a soft cloth.
- Recommended to use Genuine Accessories.

#### QUALITY MANAGEMENT SYSTEM - ISO 9001



DISCLAIMER: Our every effort has been made to ensure factual accuracy, the information presented subject to changes due to requirements in different sites, markets and/ or countries. All dimensions are in mm (Tolerance ± 5 MM). Jaquar reserves the right to make the necessary amendments at any time without prior notice.

# For Installation Refer Actual Product.Last modified on 17 April 2025.